

HOMER HARDWARE INC.



HOMER® 宏茂五金 2018-2019

BUCKLE / SEAT BELT / PART / STRIKER / LATCH / HOOK / HINGE



公司簡介 ABOUT US

本公司成立十多年以來專精五金、塑膠、鋅、鋁等各項產品生產製造。從開發生產、包裝、出貨，我們有一貫化的作業流程，嚴格的品檢制度，控管產品品質，提高效率、以達到客戶需求。

在製造生產方面，公司備有CNC / 自動化沖床20T-400T、加工母機、各項檢測設備、儀器及專業技術人員，以精密的製造技術，生產高品質的產品。

非常感謝客戶們長期以來的支持照顧，今後我們將堅持著「誠信經營」、「不斷創新」、「持續改善」之理念，繼續為您們服務。

HOMER HARDWARE INC. has been specialist producing furniture hardware, plastic hardware, die casting products, and CNC machine parts for more than a decade.

Our products include: auto parts, automobile lock, door locker, cabinet knob, and etc.

During these years, we have invested hi-tech machines, and quality control facilities to ensure our quality products and best service. In order to continuing our good reputation of business, we are sure to keep offering service under our philosophic of "honest management", "continuous creativeness", and "consecutive improvement".

We sincerely welcome your valuable suggestions and product orders.



機械設備 PRODUCTION EQUIPMENT

QC EQUIPMENT

品檢設備

- 投影機 projector
- 鹽霧測試機 salt spray tester
- 硬度測試機 hardness tester
- 拉力測試機 pull tester



PRESSES WORKSHOP

沖床自動化



LASER MACHINE

雷射



THE DIE CASTING MACHINE

鑄造設備

品質管理 QUALITY MANAGEMENT



榮獲ISO 9001:2008 CERTIFACATION 優質生產力・創造企業競爭力

以顧客需求做為品質管理系統的核心，以顧客的滿意度做為品質管理系統改善與精進的基礎，並致力於流程改善，超越顧客的期望是我們的目標；從原料的購入、檢驗到生產的品質管控，都受到嚴格的規範。在不斷的精益求精的品質保證的運作下，我們獲得 ISO 9001:2008 之國際標準品質管理系統認證。

Our goal is to exceed customer expectations by employing customer satisfaction as the core element for the modification and improvement of our quality control system.

From the purchasing and examination of raw materials, to quality control of our production; our entire production process is under strict regulation.

As we strive towards ever-improving quality, we are rewarded with ISO 9001:2008 certification for our Quality Management System.

安全扣 01 / BUCKLE
安全帶 13 / SEAT BELT
零件 15 / PART
車扣 18 / STRIKER
扣件 20 / LATCH
安全鉤 23 / HOOK
鉸鍊 24 / HINGE



CA-0100E



CA-0120E PAT

CW-1111



2" STEEL + ABS

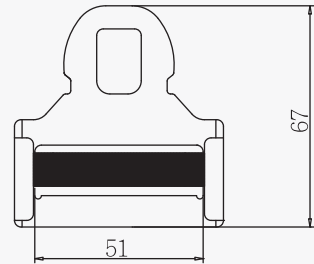

CW-1121



1.5" STEEL + ABS

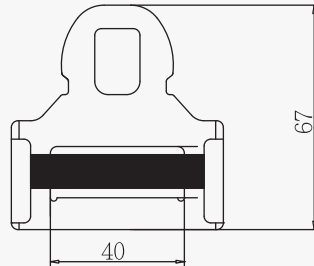

CW-1211



2" STEEL + ABS

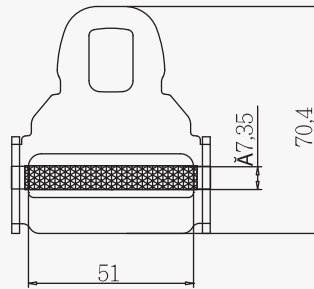

CW-1212



2" STEEL + ABS

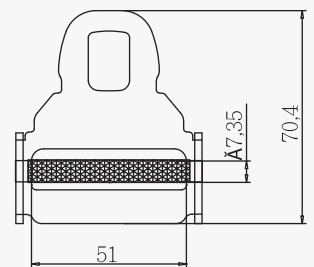



CW-1001A



1" STEEL + ABS

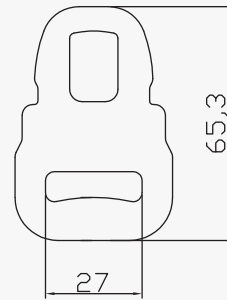

CW-1231



1.5" STEEL + ABS

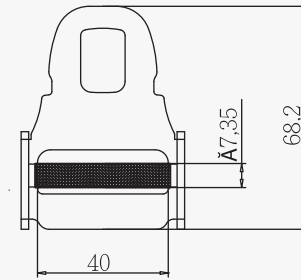

CW-1232



1.5" STEEL + ABS

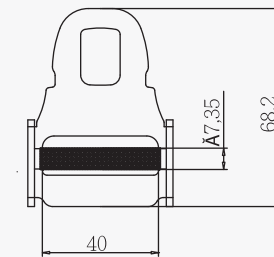

CW-1005



2" STEEL + ABS

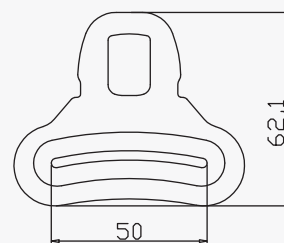

CA-0200E



CW-2001



2" ABS + STEEL

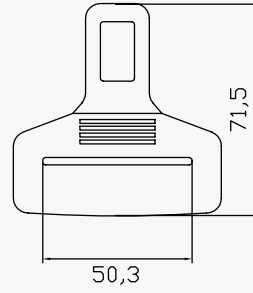

CW-2122



2" ABS + STEEL

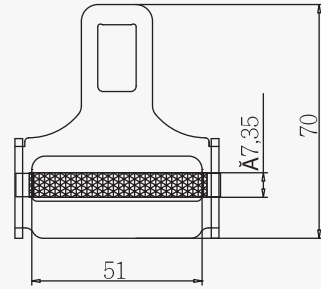





CA-0300A



CA-0303A1



CA-0306A

CW-3001

2" STEEL + ABS

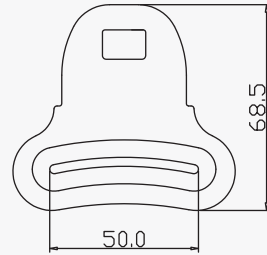

CW-3002

1" STEEL

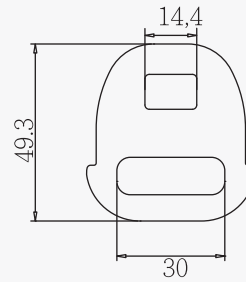

CW-3003

1" STEEL

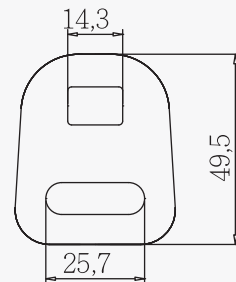

CW-3004

1" STEEL

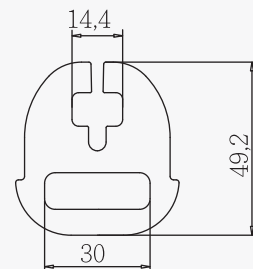
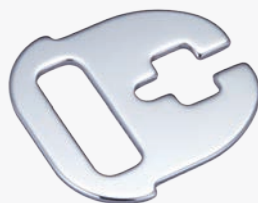



CA-0310A1



CA-0360A

CW-3005A



1" STEEL + ABS

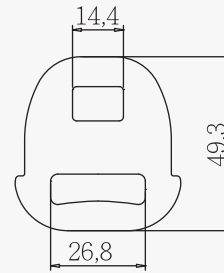

CW-3111



2" STEEL + ABS

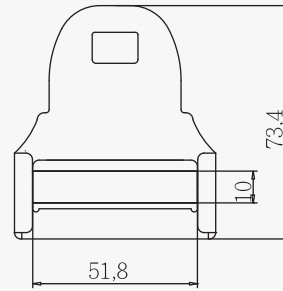

CW-3211



2" STEEL

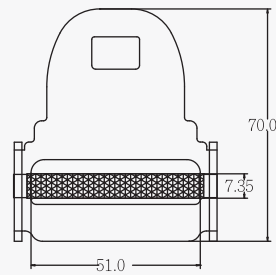

CW-3222



2" STEEL + ABS

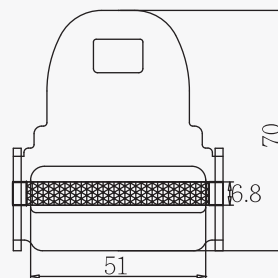

CA-0410G1



CW-4001

2" STEEL

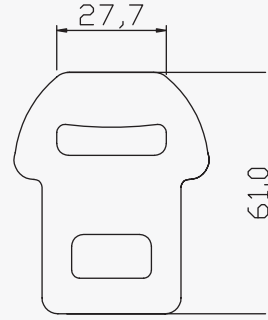



CB-042
PAT



CB-041
PAT



CA-0500A



CA-0502A1

CW-5002

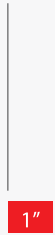

1" STEEL

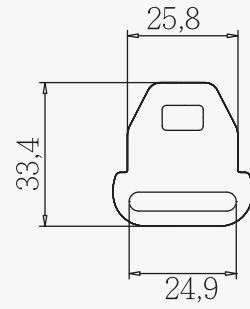

CW-5111

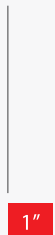

1" STEEL + ABS

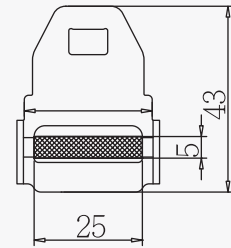

CA-0600A



CW-6001



2" STEEL / SS304

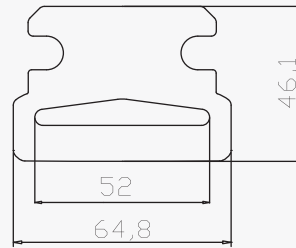

CW-6111



2" STEEL + ABS

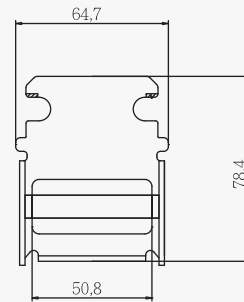

CA-0700A



CW-7001



1.5" STEEL

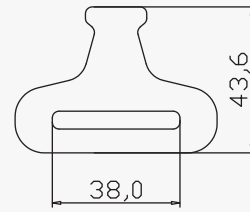

CW-7002



1.8" STEEL

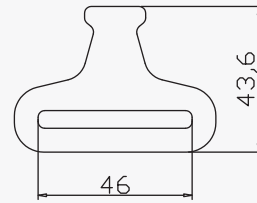



CA-0800



CW-8001



1" STEEL

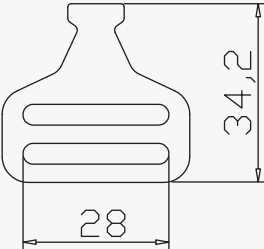

HINGE / HOOK / LATCH / STRIKER / PART / SEAT BELT / BUCKLE

CD-0100E-A01

24.4"+47"



CD-0200E-A01

24.4"+47"



CD-0300A-B01

24.4"+47"



CD-0306A-A01

24.4"+47"



CD-0410G1-A01

24.4"+47"



CD-0502A1-A01

20"



CQ-200A-B01

24.4"+47"



CQ-500E-A01

24.4"+47"



CY-003

T: 2.8 mm STEEL

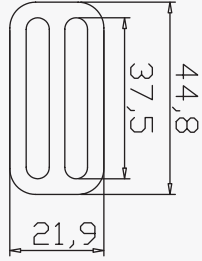

CY-004

T: 3.2 mm STEEL

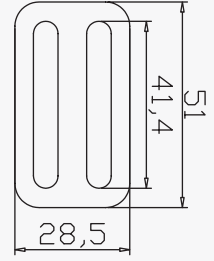

CY-005

T: 3.5 mm STEEL

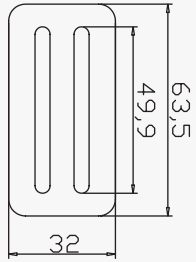

CY-006

T: 1.8 mm STEEL

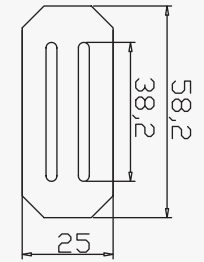
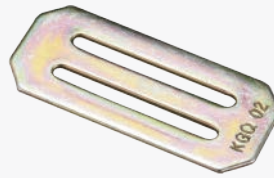

CY-007

T: 2.5 mm STEEL

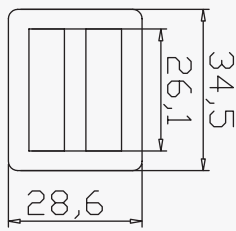

CY-008

STEEL
Hole: Ø12.7mm & 15.7mm

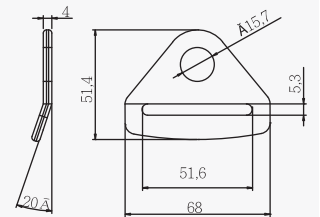

CY-011A

T: 4 mm STEEL

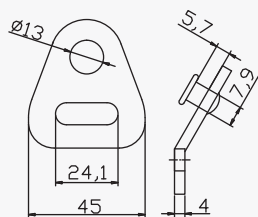

CY-015A

T: 3 mm STEEL

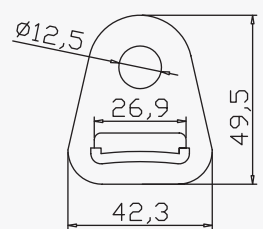

CY-016

STEEL + PA6

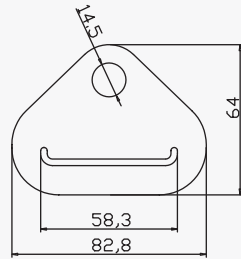

CY-017

T: 3 mm STEEL

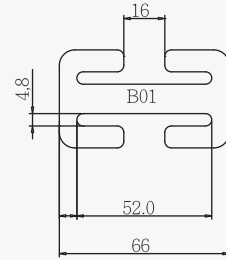

CY-022

T: 5 mm STEEL

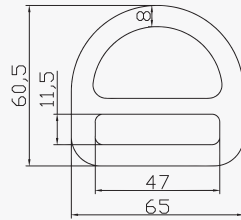

CY-039

T: 5 mm STEEL

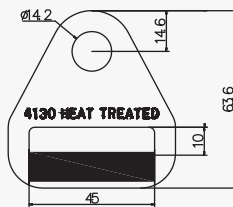

CY-041

Zinc Alloy

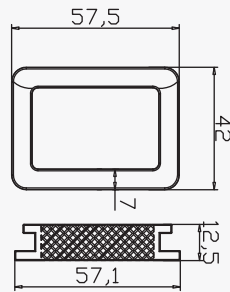

CY-044

T: 2.5 mm STEEL + ABS

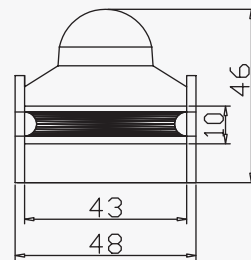

CY-045

T: 2.3 mm STEEL + ABS

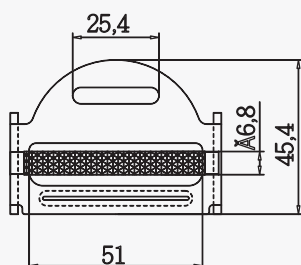

CY-045A

T: 2.3 mm STEEL + ABS

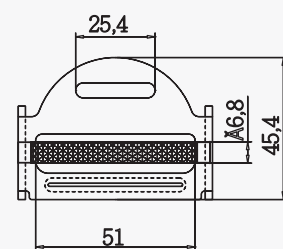

CY-046

T: 3 mm ALUMINUM

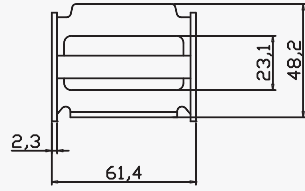

Exchange

CY-048

T: 3 mm STEEL + ABS

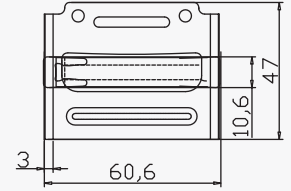

CY-049

T: 4.5 mm PE

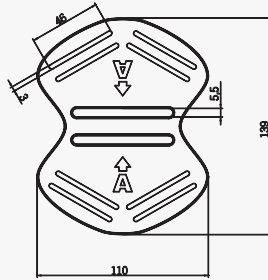

CY-901A

STEEL
Hole: Ø16.3mm & Ø15.2mm

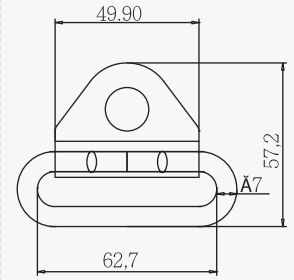

YA-001L/R

STEEL

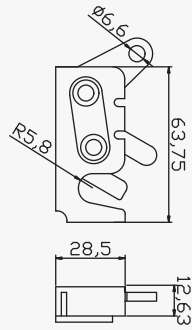

YB-001

STEEL

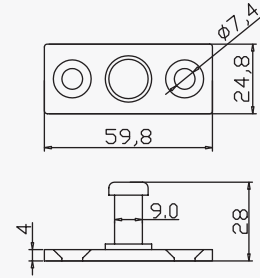

YB-002

STEEL

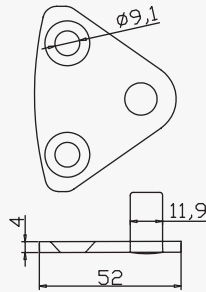

YC-010 短

STEEL

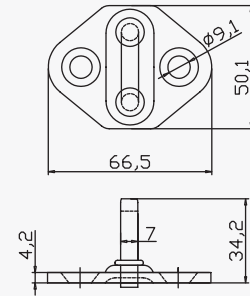

YC-011A 長

STEEL

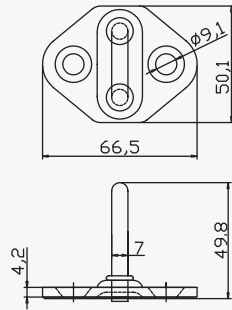

YC-012 短

STEEL

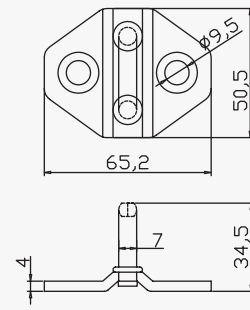

YC-013A 長

STEEL

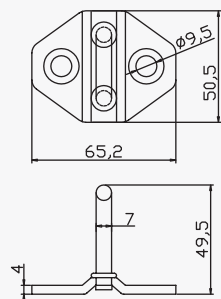

YC-021

STEEL

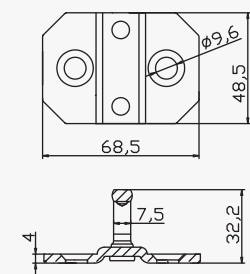

YC-022

STEEL

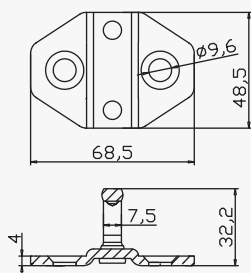
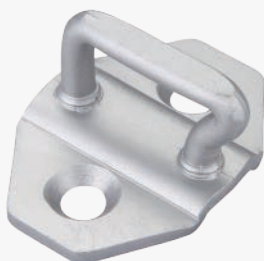

YC-023

STEEL

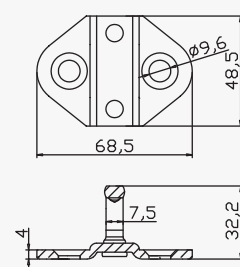

YC-024

STEEL

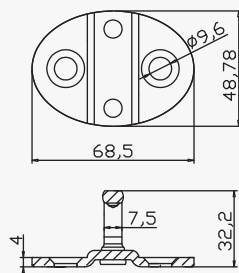

TA-001

STEEL

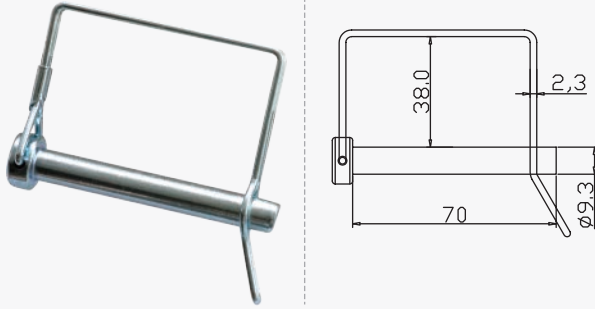

TA-002

STEEL

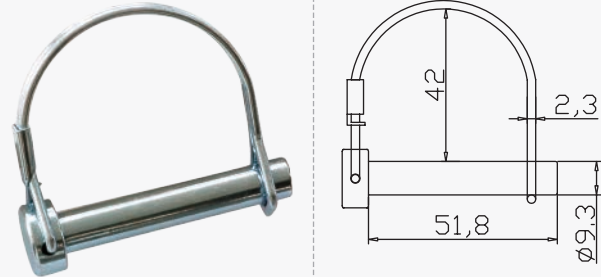

TA-003

STEEL

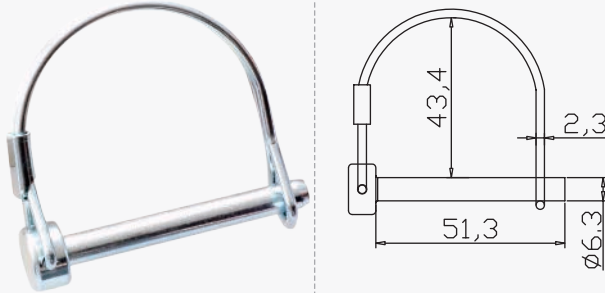

TB-001

SS304

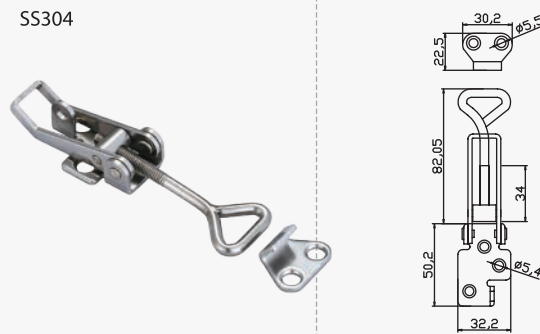

TB-002

SS304

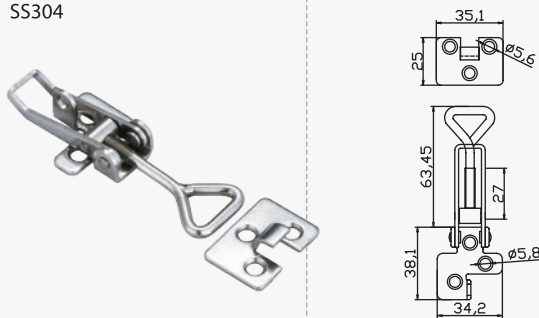

TB-003

SS304

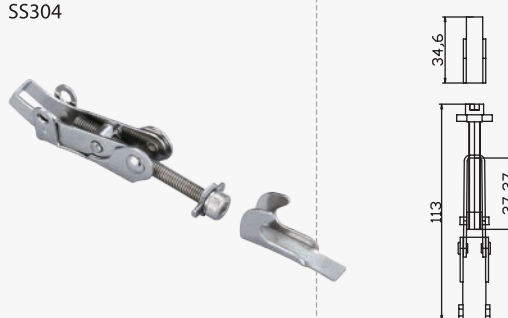

TB-003A

SS304

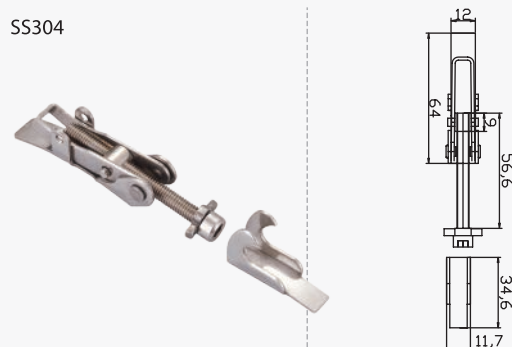

TB-004

STEEL / SS304



TB-004B

STEEL / SS304

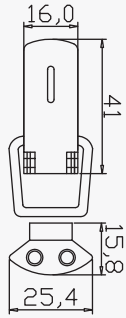

TB-005

STEEL

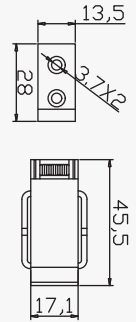
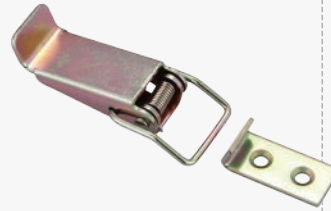

TB-006

STEEL / SS304

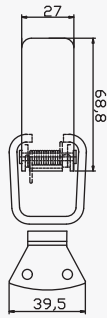

TB-006A

STEEL / SS304

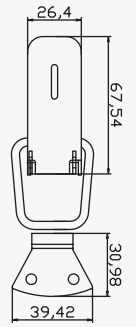

TB-010

STEEL

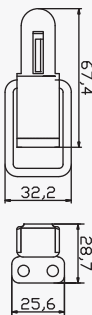

TB-011

STEEL / SS304

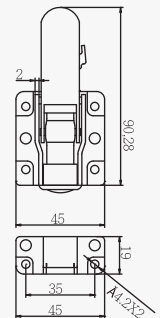
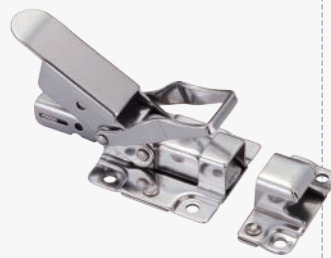

TB-015

STEEL / SS304

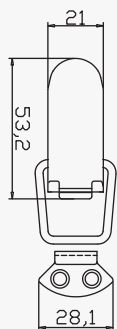

TB-015A

STEEL / SS304

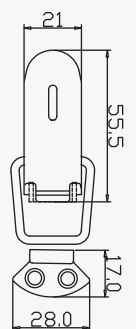

TB-025

SS304

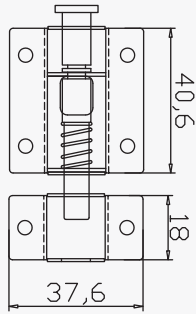

TB-026

SS304

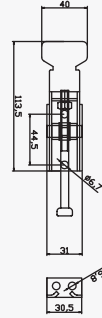

TB-027

SS304

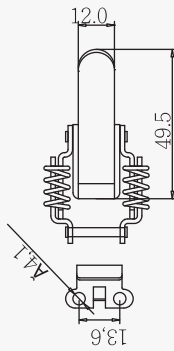

TB-027A

SS304

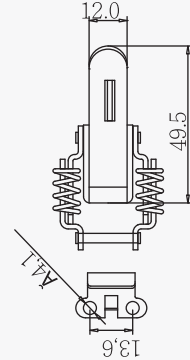
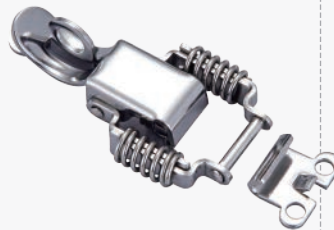

TB-030

SS304

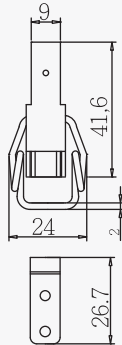

TB-031

SS304

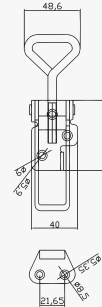

TB-032

SS304

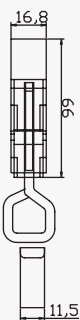

TB-033

STEEL

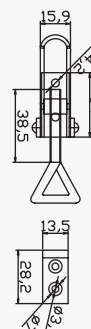

TB-034

SS304

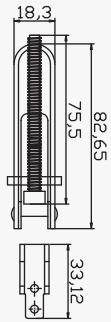

TB-035

SS304

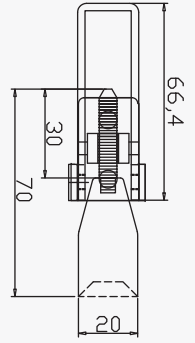

TB-036

SS304

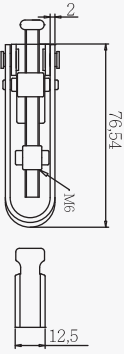

TB-037

SS304

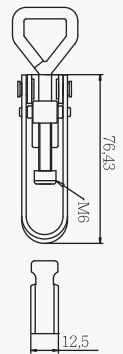

TB-039

SS304

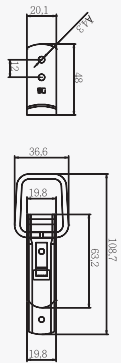

TC-010

T: 4 mm STEEL

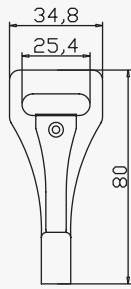

TC-020

T: 2.35 mm STEEL

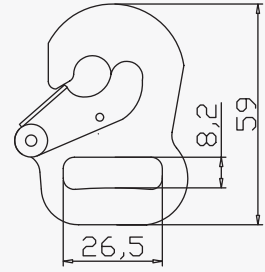

YD-001

96 x 102 x 6.2 mm STEEL

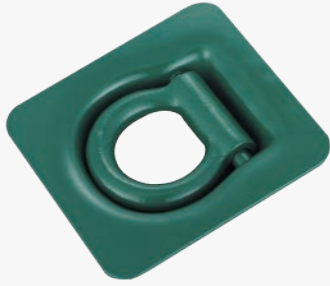

YE-010L/R

117 x 187 x 8 mm STEEL



YE-020L/R

75 x 164 x 6 mm STEEL



YE-021L/R

75.5 x 210 x 6 mm STEEL



YE-030L/R

67 x 24 x 4.2 mm STEEL



YE-031L/R

63 x 288 x 6.2 mm STEEL



YE-032L/R

59.5 x 188 x 3.5 mm STEEL



YE-040L/R

74 x 209 x 9 mm STEEL





HOMER HARDWARE INC.

500 彰化市寶廊路248號

No.248, Baobu Rd., Changhua City, Changhua County, Taiwan

Tel : 886-4-727-3349 Fax : 886-4-724-6499

E-Mail : 888@homer888.com.tw Url : www.homer888.com.tw/

Web : www.homer888.com